

# Pro Components

## TB331 Series

UL Pending

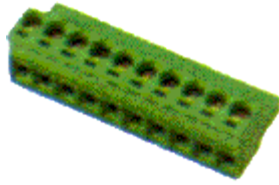

TB331

### SPECIFICATIONS:

Housing material: Polyamide 66 (UL 94V-0) resin  
 Terminals: Tin plated over Brass  
 Screws: Zinc plated over Steel  
 Wire cage: Nickel Plated over Zinc Alloy  
 Wire protector: Nickel plated over Brass  
 Dielectric strength: 2000 VAC (Min.)  
 Wire range: 12 AWG to 24 AWG  
 Insulation resistance: 500 MΩ, 500 VDC  
 Rated: 10 Amp, 300 VAC

**PITCH=5.0mm (0.197inch)**  
**WIRE RANGE: 12-24 AWG**

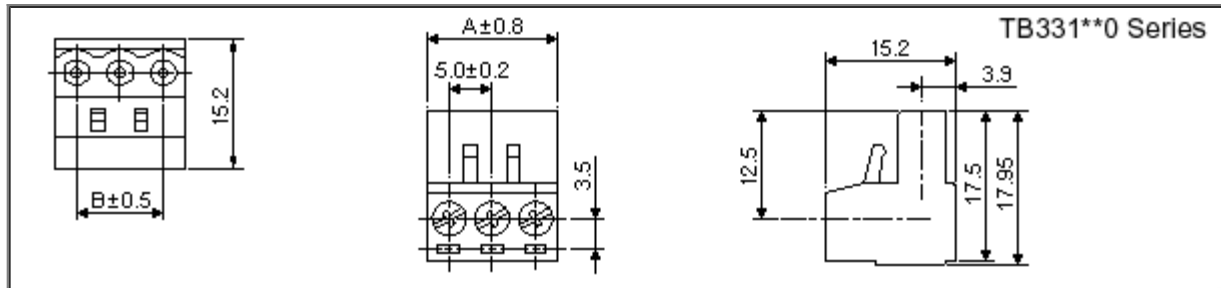

DIMENSIONS: mm(inch)

\*\*NUMBER OF POLE 02~16

POLE	2	3	4	5	6	7	8	9	10	11	12	13	14	15	16
A±0.8	10.0 (0.394)	15.0 (0.590)	20.0 (0.787)	25.0 (0.984)	30.0 (1.181)	35.0 (1.378)	40.0 (1.575)	45.0 (1.772)	50.0 (1.969)	55.0 (2.165)	60.0 (2.362)	65.0 (2.559)	70.0 (2.756)	75.0 (2.953)	80.0 (3.150)
B±0.5	5.0 (0.197)	10.0 (0.394)	15.0 (0.590)	20.0 (0.787)	25.0 (0.984)	30.0 (1.181)	35.0 (1.378)	40.0 (1.575)	45.0 (1.772)	50.0 (1.969)	55.0 (2.165)	60.0 (2.362)	65.0 (2.559)	70.0 (2.756)	75.0 (2.953)

## FEATURES

- Special wire protector design to ensure reliable wire clamping
- Be capable of clamping a wide range of wire diameters
- The male connector of plug is mounted and soldered to the P.C.B.
- The female socket using a twin leaf phosphor bronze contact mates with the male
- UL 94V-0 grade fire retardant engineering plastic used for the housing
- Good for insertion & withdrawal

## PART NUMBERING SYSTEM

